

OUTLINE DIMENSION

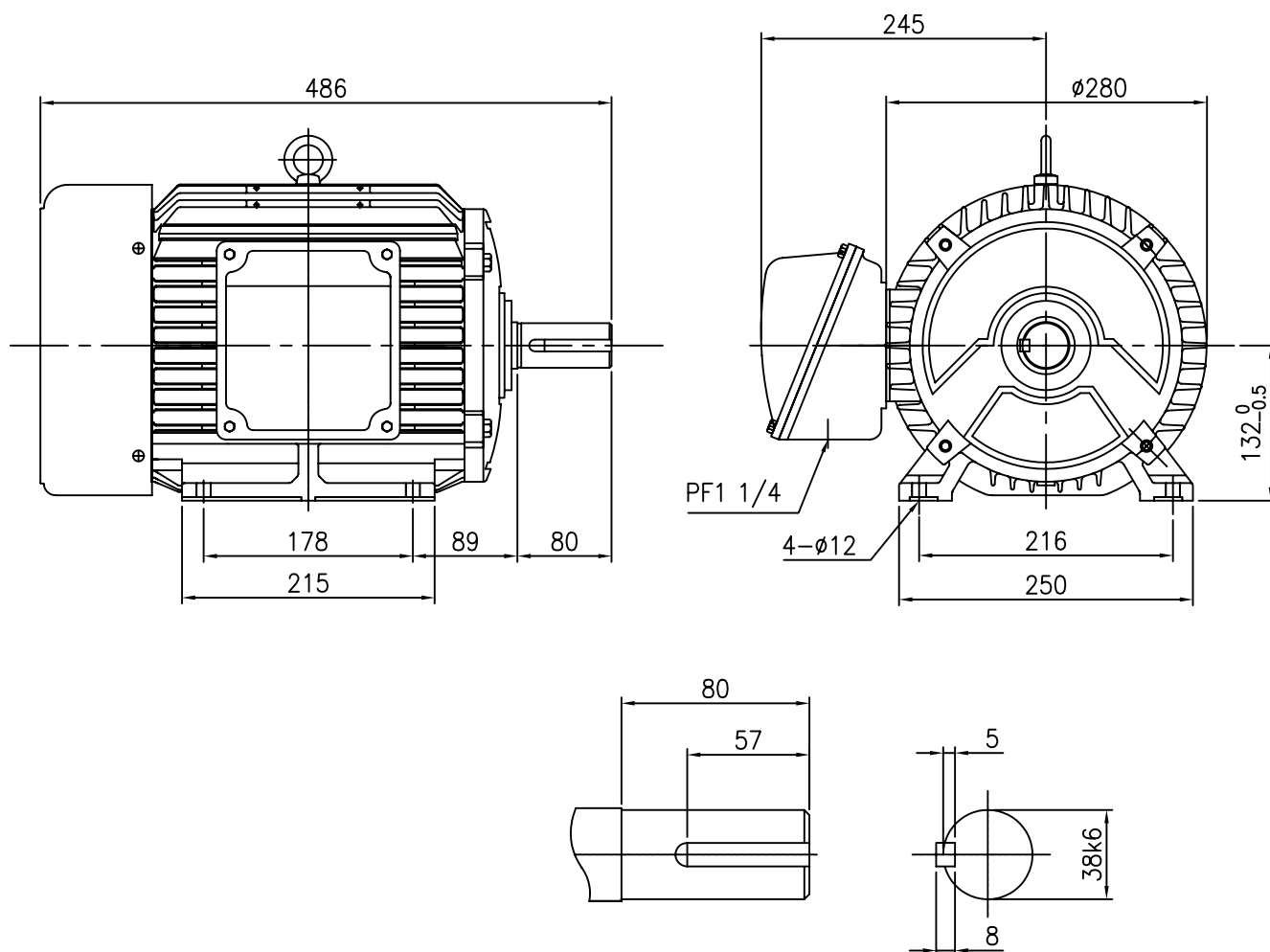

<NOTE>

1. TYPE : TEFC(Totally Enclosed Fan Cooled)
FOOT MOUNTED TYPE

2. THE TOLERANCE FOR THE KEY DIMENSIONS
IS IN ACCORDANCE WITH KS B 1311-84

3. THE TERMINAL BOX MAY BE ROTATED
STEPS OF 90°

SHAFT EXTENSION

4. CAST IRON FRAME AND END BRACKETS.

5. STAINLESS STEEL NAME PLATE WITH
CONNECTION DIAGRAM.

6. STEEL FAN COVER AND CAST IRON TERMINAL BOX.

| FRAME NO. | OUTPUT (kW) | POLE (P) | Hz | VOLTS (V) | INS. CLASS | PROTECTION | RATING | BEARING NO. | | APPROX. WEIGHT (Kg) |
|-----------|-------------|----------|----|-----------|------------|------------|--------|-------------|--------|---------------------|
| | | | | | | | | DRIVE | OPP.D. | |
| 132M | 7.5 | 4 | 60 | 440 | F | IP54 | CONT. | 6208ZZ | 6206ZZ | 80 |

| UNIT | mm | SCALE | $\frac{N}{S}$ | PROJECT'N | 3rd Angle | TITLE | OUTLINE |
|-----------------------|----|----------------------|---------------|-----------------------|-----------|----------|--------------------|
| DESIGNED | | CHECKED | | APPROVED | | | |
| 2009.06.29 S.M.KIM | | 2009.06.29 K.I.HA | | 2009.06.29 H.J.KIM | | SUBJECT | 132M, B3 |
| HIGEN Motor co., Ltd. | | | | | | DWG. NO. | DW-I10HV1HIT-PB140 |